

UHF, Mini-UHF SERIES

HIGH VOLTAGE CONNECTORS



Description

The Jy Chyun UHF/Mini UHF series is not only economical but also has been widely adapted. The UHF connectors are commonly used in bandwidth specific wireless receptors, shared GPS system among other related industry. The Mini UHF connectors boast an ultra-compact size, and are adaptable in cellular phone systems.

Applications

- Antennas
- Cellular Mobile Telephone.
- Telecommunications
- Low cost local area networks.
- Public Address Systems
- CB Radios

Specifications

UHF Electrical		Material		
Impedance	Non Constant	Component	Material	Finish
frequency Range	0-200 MHz	Center Contact	Plug : Brass	Gold or Silver plated*
Voltage Rating	500 Volts peak		Jack : Brass or Phosphor Bronze	
Mini UHF Electrical		Metal parts	Brass or Zinc diecast	Nickel plated
Impedance	50 ohm nominal	Insulators	Teflon, Phenolic, Delrin*	None
frequency Range	0-2GHz	Crimp Ferrule	Annealed Copper	Nickel plated
Working Voltage	335 Volts rms.	* UHF has silver plated center contact, phenolic insulator. Mini-UHF has gold plated center contact, Delrin or Teflon insulator.		
Dielectric Withstanding Voltage	1000Volts rms.			
VSWR	Straight : 1.3 max.			
	Right Angle : 1.5 max.			
Insulation Resistance	5000 megohms(min)			

Interface Mating Dimensions

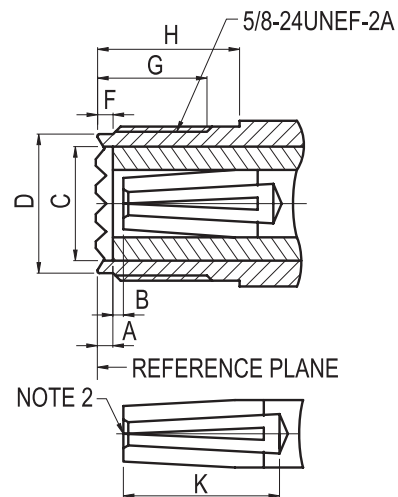
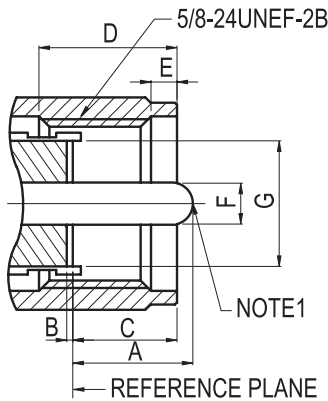

PLUG		
Letter	Millimeters	
	Minimum	Maximum
A	-	11.10(.437)
B	0.00	-
C	-	9.91(.390)
D	8.76(.345)	-
E	1.19(.047)	4.27(.168)
F	3.91(.154)	4.01(.158)
G	11.56(.455)	12.22(.481)

JACK		
Letter	Millimeters	
	Minimum	Minimum
A	1.02(.040)	-
B	0.03(.001)	-
C	11.56(.455)	12.22(.481)
D	-	14.25(.561)
F	1.19(.047)	1.96(.077)
G	7.87(.310)	-
H	11.10(.437)	-
K	11.76(.463)	-

NOTE1 : FORM OF INNER CONDUCTOR OPTIONAL.

NOTE2 : I.D. TO MEET GOOD ELECTRICAL CONTACT WHEN MATED WITH 3.91/4.01MM DIA. PIN.

Flexible Cable

STRAIGHT PLUG, Crimp

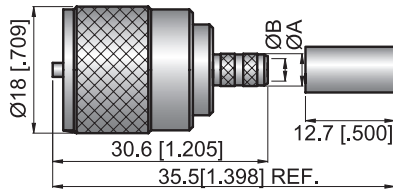

Part Number.	Cable Type	Dimension	
		A	B
UHF-C5611101R4	RG58.RG141.RG303	4.6(.181)	3.2(.126)

Flexible Cable

STRAIGHT PLUG, Solder

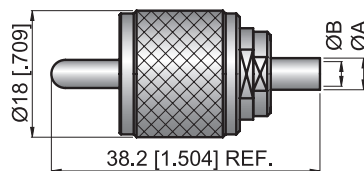

Part Number.	Cable Type	Dimension	
		A	B
UHF-C5612101D1	1.5D-2V	4.5(.177)	3.5(.138)
UHF-C5612101D3	3D-2V	7(.276)	5.5(.217)
UHF-C5612102D7	5D-FB	9.5(.374)	8.3(.327)
UHF-C5612102D8	8D-FB	13(.512)	11.5(.453)

Flexible Cable

STRAIGHT PLUG, Crimp

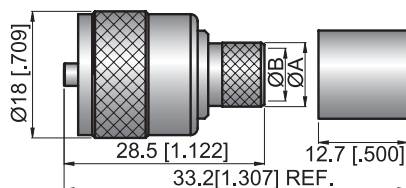

Part Number.	Cable Type	Dimension	
		A	B
UHF-C5611101R2	RG8.RG213	9.1(.358)	7.5(.295)

Flexible Cable

STRAIGHT PLUG, Solder

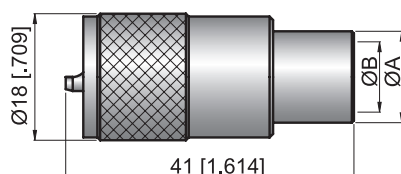

Part Number.	Cable Type	Dimension	
		A	B
UHF-C5612101D7	5D-FB	9.5(.374)	8.3(.327)
UHF-C5612101D8	8D-FB	13(.512)	11.5(.453)

Flexible Cable

STRAIGHT PLUG, Solder

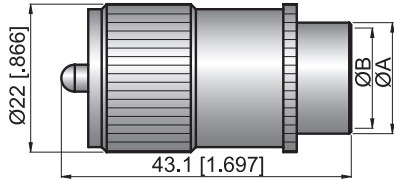

Part Number.	Cable Type	Dimension	
		A	B
UHF-C5612101D9	10D-FB	16.5(.650)	14.9(.587)

Flexible Cable

RIGHT ANGLE JACK, Solder

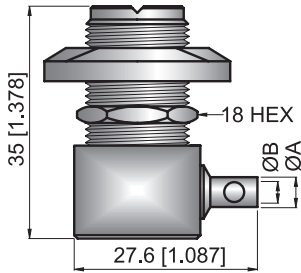

Part Number.	Cable Type	Dimension	
		A	B
UHF-C5722101D1	1.5D-2V	4.5(.177)	3.5(.138)
UHF-C5722101D3	3D-2V	7(.276)	5.5(.217)
UHF-C5722101D7	5D-FB	9.5(.374)	8.3(.327)
UHF-C5722101D8	8D-FB	13(0.51)	11.5(0.45)

Flexible Cable, Solder

RIGHT ANGLE JACK, Clamp

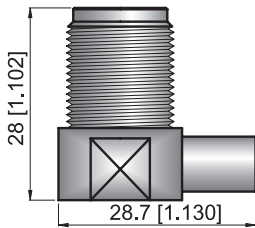

Part Number.	Cable Type	Dimension	
		A	B
UHF-C5727101R4	RG58.RG141.RG303		

Flexible Cable, Solder

RIGHT ANGLE JACK, Crimp

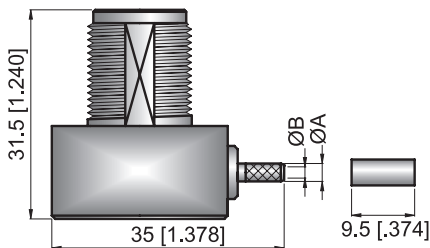

Part Number.	Cable Type	Dimension	
		A	B
UHF-C5721101R5	RG174.RG188.RG316	2.7(.106)	1.7(.067)

Bulkhead Receptacle

BULKHEAD STRAIGHT JACK-FRONT MOUNT

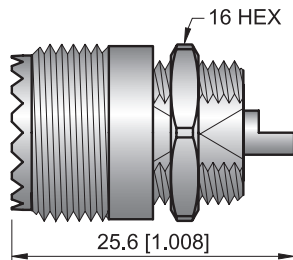

Part Number.	Cable Type	Dimension	
		A	B
UHF-C5714105Z0			

Bulkhead Receptacle

BULKHEAD STRAIGHT JACK

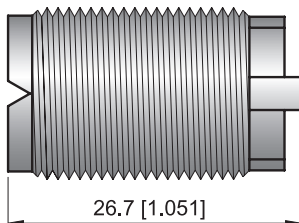

Part Number.	Cable Type	Dimension	
		A	B
UHF-C5714101Z0			

Bulkhead Receptacle

BULKHEAD STRAIGHT JACK- FRONT MOUNT

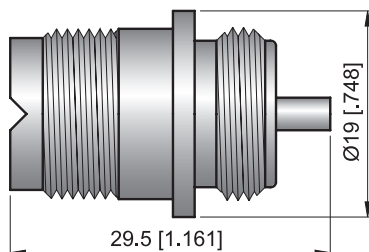

Part Number.	Cable Type	Dimension	
		A	B
UHF-C5714102Z0			

Bulkhead Receptacle

BULKHEAD STRAIGHT JACK- FRONT MOUNT

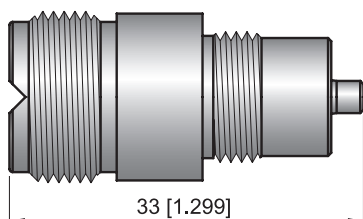

Part Number.	Cable Type	Dimension	
		A	B
UHF-C5714104Z0			

Bulkhead Receptacle

BULKHEAD STRAIGHT JACK-FRONT MOUNT

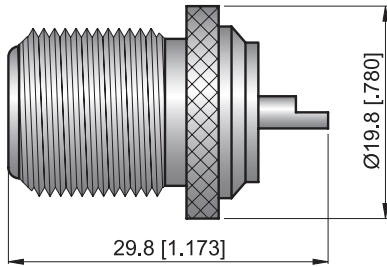

Part Number.	Cable Type	Dimension	
		A	B
UHF-C5714103Z0			

Antenna

STRAIGHT PLUG, Solder

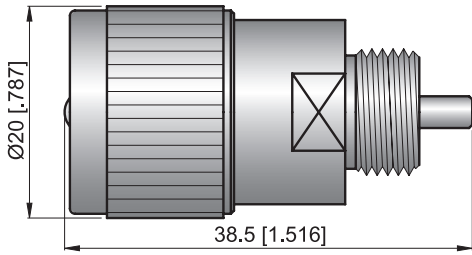

Part Number.	Cable Type	Dimension	
		A	B
UHF-C5612101A1			

Antenna

STRAIGHT PLUG, Solder

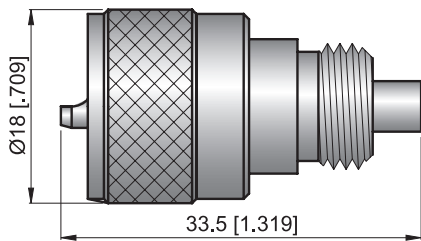

Part Number.	Cable Type	Dimension	
		A	B
UHF-C5612102A1			

Antenna

STRAIGHT PLUG, Clamp

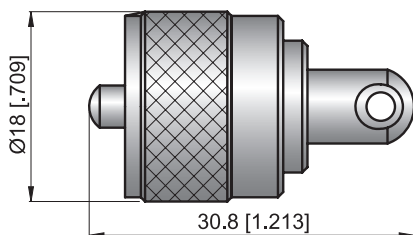

Part Number.	Cable Type	Dimension	
		A	B
UHF-C5617103A1			

Antenna

STRAIGHT PLUG, Solder

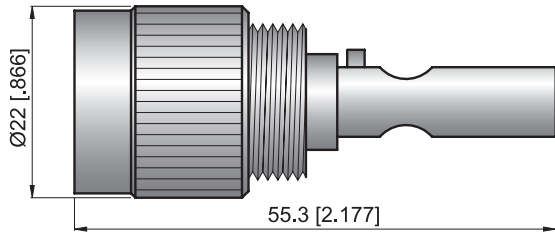

Part Number.	Cable Type	Dimension	
		A	B
UHF-C5612104A1			

Flexible Cable

STRAIGHT PLUG, Crimp

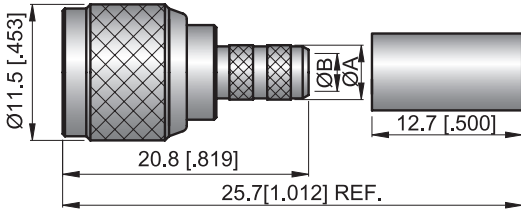

Part Number.	Cable Type	Dimension	
		A	B
MUHF-C5611101R4	RG58.RG141.RG303	4.6(.181)	3.2(.126)

Flexible Cable

STRAIGHT JACK, Crimp

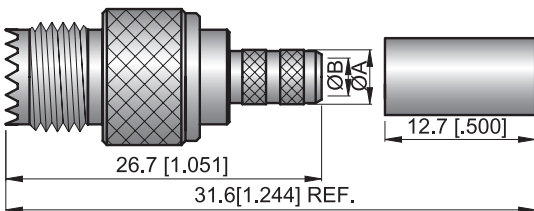

Part Number.	Cable Type	Dimension	
		A	B
MUHF-C5711101R4	RG58.RG141.RG303	4.6(.181)	3.2(.126)

Flexible Cable

STRAIGHT JACK, Crimp

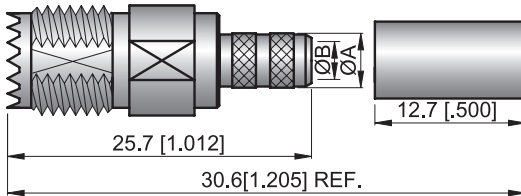

Part Number.	Cable Type	Dimension	
		A	B
MUHF-C5711102R4	RG58.RG141.RG303	4.6(.181)	3.2(.126)

Bulkhead RECEPTACLE

BULKHEAD STRAIGHT JACK

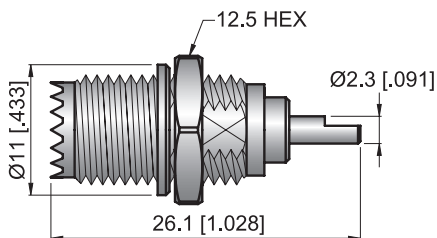

Part Number.	Cable Type	Dimension	
		A	B
MUHF-C5714101Z0			

Bulkhead RECEPTACLE

BULKHEAD STRAIGHT JACK

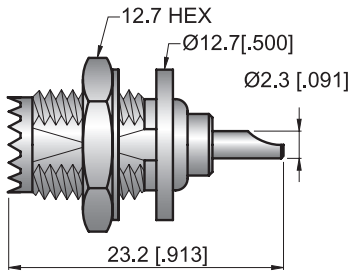

Part Number.	Cable Type	Dimension	
		A	B
MUHF-C5714102Z0			