

N SERIES

COAXIAL CONNECTORS



Description

The Jy Chyun coaxial N connectors are largely products designed to support the applications of the receptor antennas, station equipment, communication systems, and for test instruction products. The 50 ohm impedance-rating framework that is compatible for a bandwidth ranging from DC to 11GHz, while the 75 ohm model compatible to a bandwidth ranging from DC to 1.5 GHz, bringing the user a wider range of applications.

Applications

- Antennas
- Instrumentation
- LANs
- Test & Measurement
- Base Stations
- Broadcast
- Microwave Components
- Transmitters
- Receivers
- Radar

Specifications

| Electrical | | Material | | |
|---------------------------------|----------------------------------|--|---|--------------|
| Impedance | 50 ohm nominal | Parts Name | Material | Finish |
| Frequency Range | 0 - 11 GHz | Center Contact | Plug: Brass | Gold plated* |
| Voltage Rating | 1500 Volts peak | | Jack: Phosphor Bronze (nominal) or Beryllium Copper | |
| Dielectric Withstanding Voltage | 2500 Volts peak | Metal parts | Brass | Nickel* |
| VSWR | Straight: 1.3 max. | Insulators | Teflon | None |
| | Right Angle: 1.5 max. | Clamp gaskets | Silicone rubber, Synthetic rubber | |
| Contact Resistance | Center Contact: 3 Milliohms Max. | Crimp Ferrules | Annealed copper | Nickel* |
| | Outer Contact: 2 Milliohms Max. | | | |
| Insulation Resistance | 5000 megohms min. | *Silver plated body or contact is only available for special requirement Note: 75 ohm series connectors are not intermateable with the 50 ohm series. | | |

Interface Mating Dimensions

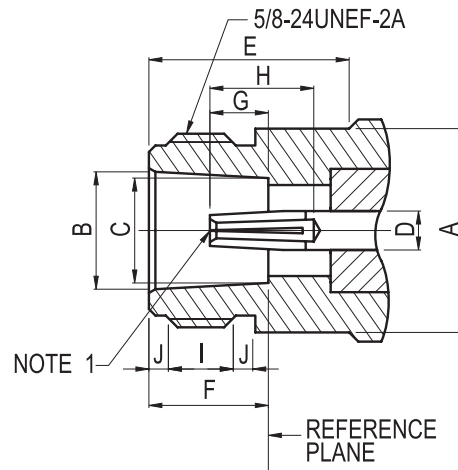
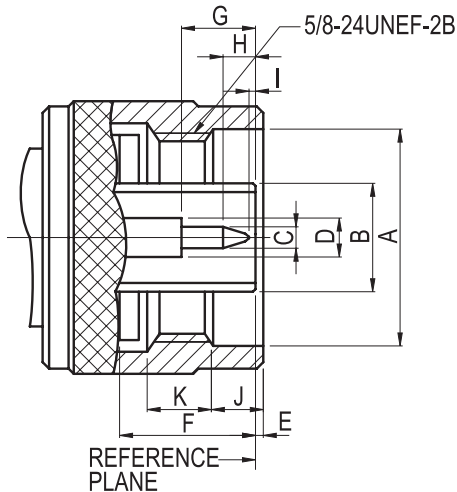

| PLUG | | |
|--------|-------------|-------------|
| Letter | Millimeters | |
| | Minimum | Maximum |
| A | 16.00(.630) | - |
| B | - | 8.38(.330) |
| C | 1.60(.063) | 1.68(.066) |
| D | 3.00(.118) | 3.15(.124) |
| E | 0.41(.016) | 1.52(.060) |
| F | 10.11(.398) | 10.46(.412) |
| G | 5.33(.210) | 5.84(.230) |
| H | 3.30(.130) | 4.32(.170) |
| I | 0.08(.003) | - |
| J | 4.01(.158) | 4.27(.168) |
| k | 4.50(.177) | 5.00(.197) |

| JACK | | |
|--------|-------------|-------------|
| Letter | Millimeters | |
| | Minimum | Minimum |
| A | - | 15.93(.628) |
| B | 8.53(.336) | 8.74(.344) |
| C | 8.03(.316) | 8.13(.320) |
| D | 3.00(.118) | 3.15(.124) |
| E | 10.72(.422) | - |
| F | 9.04(.356) | 9.19(.362) |
| G | 4.75(.187) | 5.26(.207) |
| H | 5.33(.210) | - |
| I | 4.37(.172) | 5.13(.202) |
| J | 1.19(.047) | 1.96(.077) |

NOTE 1 : I.D. TO MEET VSWR AND CONTACT RESISTANCE WHEN MATED WITH 1.6/1.68 MM DIA. PIN.

Semi-Rigid Cable

STRAIGHT PLUG, Solder

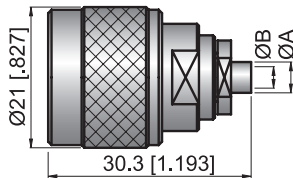

| Part Number. | Cable Type | Dimension | |
|--------------|-----------------|-----------|-----------|
| | | A | B |
| N-C5612101S3 | Semi-Rigid .085 | 3.2(.126) | 2.2(.087) |
| N-C5612101S4 | Semi-Rigid .141 | 4.6(.181) | 3.6(.142) |

Semi-Rigid Cable

STRAIGHT JACK, Solder

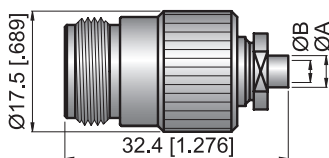

| Part Number. | Cable Type | Dimension | |
|--------------|-----------------|-----------|-----------|
| | | A | B |
| N-C5712101S3 | Semi-Rigid .085 | 3.2(.126) | 2.2(.087) |
| N-C5712101S4 | Semi-Rigid .141 | 4.6(.181) | 3.6(.142) |

Semi-Rigid Cable

RIGHT ANGLE PLUG, Solder

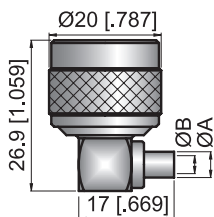

| Part Number. | Cable Type | Dimension | |
|--------------|-----------------|-----------|-----------|
| | | A | B |
| N-C5622102S3 | Semi-Rigid .085 | 3.2(.126) | 2.2(.087) |
| N-C5622102S4 | Semi-Rigid .141 | 4.6(.181) | 3.6(.142) |

Semi-Rigid Cable

BULKHEAD STRAIGHT JACK, Solder

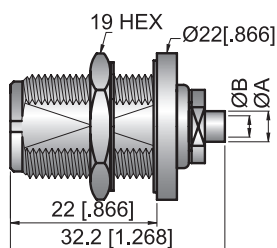

| Part Number. | Cable Type | Dimension | |
|--------------|-----------------|-----------|-----------|
| | | A | B |
| N-C5714102S3 | Semi-Rigid .085 | 3.2(.126) | 2.2(.087) |
| N-C5714102S4 | Semi-Rigid .141 | 4.6(.181) | 3.6(.142) |

Semi-Rigid Cable

4-HOLE PANEL STRAIGHT PLUG, Solder

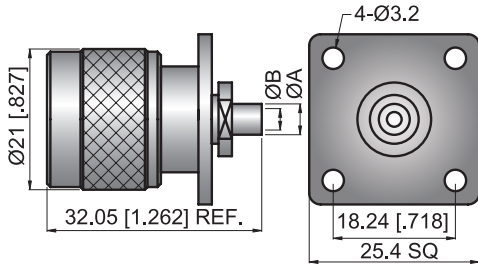

| Part Number. | Cable Type | Dimension | |
|--------------|-----------------|-----------|-----------|
| | | A | B |
| N-C5615103S3 | Semi-Rigid .085 | 3.2(.126) | 2.2(.087) |
| N-C5615103S4 | Semi-Rigid .141 | 4.6(.181) | 3.6(.142) |

Semi-Rigid Cable

4-HOLE PANEL STRAIGHT JACK, Solder

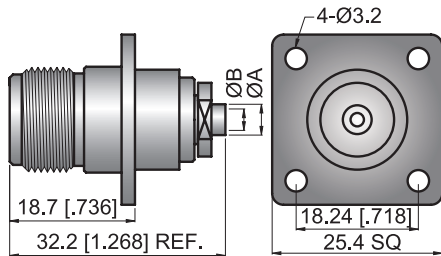

| Part Number. | Cable Type | Dimension | |
|--------------|-----------------|-----------|-----------|
| | | A | B |
| N-C5715103S3 | Semi-Rigid .085 | 3.2(.126) | 2.2(.087) |
| N-C5715103S4 | Semi-Rigid .141 | 4.6(.181) | 3.6(.142) |

Semi-Rigid Cable

4-HOLE PANEL STRAIGHT JACK, Clamp

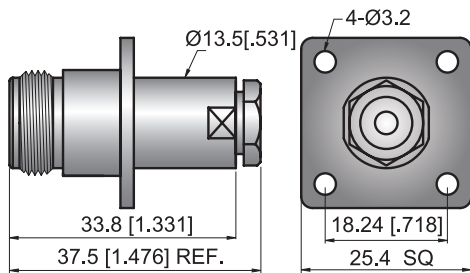

| Part Number. | Cable Type | Dimension | |
|--------------|-----------------|-----------|---|
| | | A | B |
| N-C5715101S5 | Semi-Rigid .250 | | |

Semi-Rigid Cable

STRAIGHT PLUG, Clamp

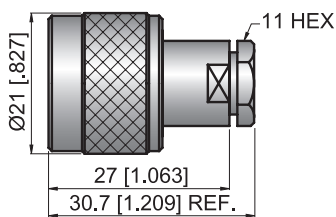

| Part Number. | Cable Type | Dimension | |
|--------------|-----------------|-----------|---|
| | | A | B |
| N-C5617101S5 | Semi-Rigid .250 | | |

Flexible Cable

STRAIGHT PLUG - SIDE SOLDER TYPE

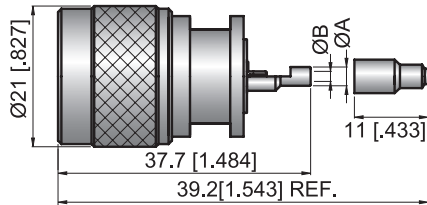

| Part Number. | Cable Type | Dimension | |
|--------------|------------|-----------|-----------|
| | | A | B |
| N-C5613101M1 | Ø1.13/mm | 2.8(.110) | 2.1(.083) |

Flexible Cable

STRAIGHT JACK - SIDE SOLDER TYPE

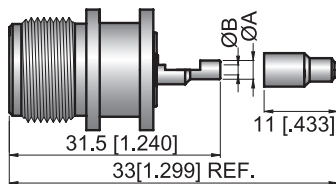

| Part Number. | Cable Type | Dimension | |
|--------------|------------|-----------|-----------|
| | | A | B |
| N-C5713101M1 | Ø1.13/mm | 2.8(.110) | 2.1(.083) |

Flexible Cable

BULKHEAD STRAIGHT JACK - SIDE SOLDER TYPE

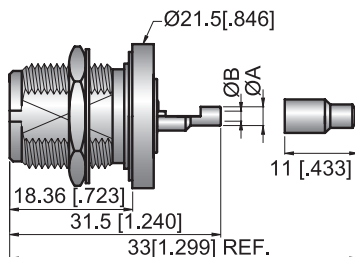

| Part Number. | Cable Type | Dimension | |
|--------------|------------|-----------|-----------|
| | | A | B |
| N-C5714102M1 | Ø1.13/mm | 2.8(.110) | 2.1(.083) |

Flexible Cable

4-HOLE PANEL STRAIGHT JACK, Crimp - SIDE SOLDER TYPE

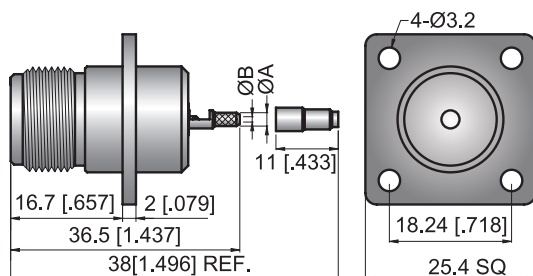

| Part Number. | Cable Type | Dimension | |
|--------------|------------|-----------|-----------|
| | | A | B |
| N-C5715103M1 | Ø1.13/mm | 2(.079) | 0.8(.031) |

Flexible Cable

STRAIGHT PLUG, Crimp

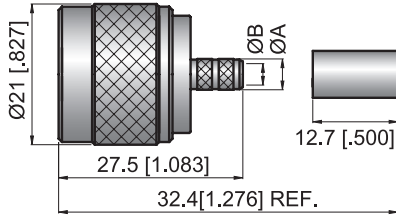

| Part Number. | Cable Type | Dimension | |
|--------------|------------------------|-----------|-----------|
| | | A | B |
| N-C5611101R4 | RG58.RG141.RG303 | 4.6(.181) | 3.2(.126) |
| N-C5611101R3 | RG55.RG142.RG223.RG400 | 4.6(.181) | 3.2(.126) |
| N-C5611101R5 | RG174.RG188.RG316 | 2.7(.106) | 1.7(.067) |
| N-C5611101R8 | RG214 | 9.3(.366) | 7.3(.287) |

Flexible Cable

STRAIGHT PLUG, Crimp

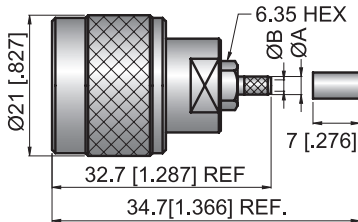

| Part Number. | Cable Type | Dimension | |
|--------------|-------------------|-----------|-----------|
| | | A | B |
| N-C5611102R5 | RG174.RG188.RG316 | 2.7(.106) | 1.7(.067) |
| N-C5611102R4 | RG58.RG141.RG303 | 4.6(.181) | 3.2(.126) |

Flexible Cable

STRAIGHT JAKC, Crimp

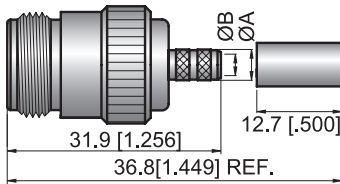

| Part Number. | Cable Type | Dimension | |
|--------------|------------------------|-----------|-----------|
| | | A | B |
| N-C5711101R4 | RG58.RG141.RG303 | 4.6(.181) | 3.2(.126) |
| N-C5711101R3 | RG55.RG142.RG223.RG400 | 4.6(.181) | 3.2(.126) |
| N-C5711101R5 | RG174.RG188.RG316 | 2.7(.106) | 1.7(.067) |

Flexible Cable

RIGHT ANGLE PLUG, Crimp

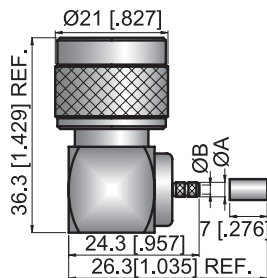

| Part Number. | Cable Type | Dimension | |
|--------------|-------------------|-----------|-----------|
| | | A | B |
| N-C5621103R5 | RG174.RG188.RG316 | 2.7(.106) | 1.7(.067) |
| N-C5621103R4 | RG58.RG141.RG303 | 4.6(.181) | 3.2(.126) |
| N-C5621102R8 | RG214 | 9.3(.366) | 7.3(.287) |

Flexible Cable

BULKHEAD STRAIGHT JACK, Crimp

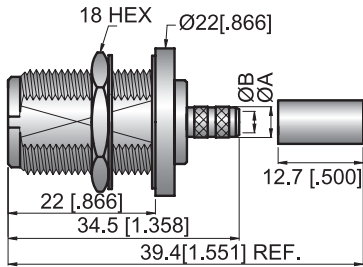

| Part Number. | Cable Type | Dimension | |
|--------------|------------------------|-----------|-----------|
| | | A | B |
| N-C5714105R4 | RG58.RG141.RG303 | 4.6(.181) | 3.2(.126) |
| N-C5714102R3 | RG55.RG142.RG223.RG400 | 4.6(.181) | 3.2(.126) |
| N-C5714104R5 | RG174.RG188.RG316 | 2.7(.106) | 1.7(.067) |

Flexible Cable

BULKHEAD STRAIGHT JACK, Crimp-PIN IN PIN CONTACT TYPE

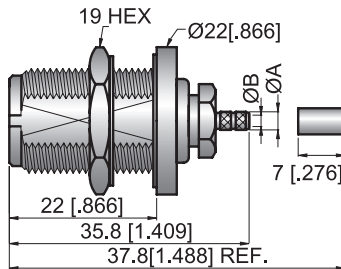

| Part Number. | Cable Type | Dimension | |
|--------------|-------------------|-----------|-----------|
| | | A | B |
| N-C5714103R5 | RG174.RG188.RG316 | 2.7(.106) | 1.7(.067) |

Flexible Cable

STRAIGHT PLUG, Clamp

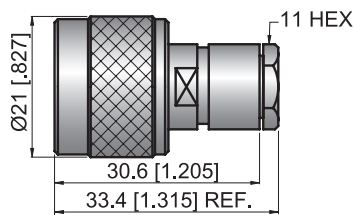

| Part Number. | Cable Type | Dimension | |
|--------------|------------------|-----------|---|
| | | A | B |
| N-C5617104R4 | RG58.RG141.RG303 | | |

Flexible Cable

STRAIGHT JACK, Clamp

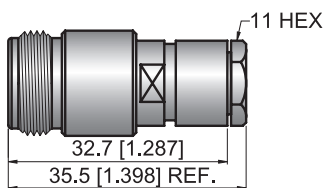

| Part Number. | Cable Type | Dimension | |
|--------------|------------------|-----------|---|
| | | A | B |
| N-C5717104R4 | RG58.RG141.RG303 | | |

Flexible Cable

STRAIGHT PLUG, Clamp

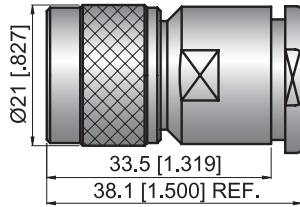

| Part Number. | Cable Type | Dimension | |
|--------------|------------|-----------|---|
| | | A | B |
| N-C5617101R2 | RG8.RG213 | | |

Flexible Cable

STRAIGHT JACK, Clamp

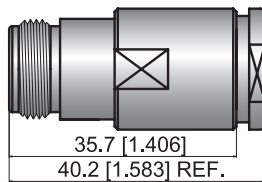

| Part Number. | Cable Type | Dimension | |
|--------------|------------|-----------|---|
| | | A | B |
| N-C5717101R2 | RG8.RG213 | | |

Flexible Cable

STRAIGHT JACK, Clamp

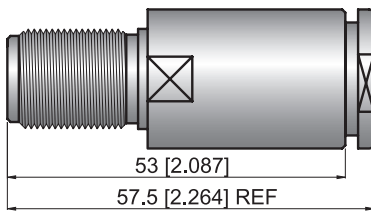

| Part Number. | Cable Type | Dimension | |
|--------------|------------|-----------|---|
| | | A | B |
| N-C5717102R2 | RG8.RG213 | | |

Flexible Cable

STRAIGHT PLUG, Solder

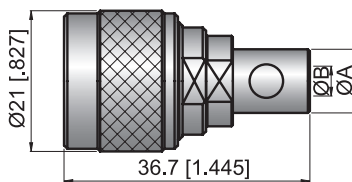

| Part Number. | Cable Type | Dimension | |
|--------------|------------|-----------|-----------|
| | | A | B |
| N-C5612102R2 | RG8.RG213 | 9.5(.374) | 8.2(.323) |

Bulkhead Receptacle

BULKHEAD STRAIGHT JACK-FRONT MOUNT

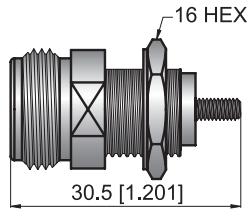

| Part Number. | Cable Type | Dimension | |
|--------------|------------|-----------|---|
| | | A | B |
| N-C5714101Z0 | | | |

Bulkhead Receptacle

BULKHEAD STRAIGHT JACK-FRONT MOUNT

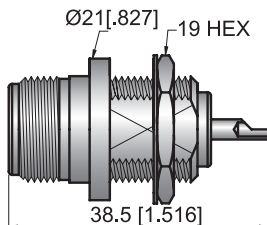

| Part Number. | Cable Type | Dimension | |
|--------------|------------|-----------|---|
| | | A | B |
| N-C5714106Z0 | | | |

Bulkhead Receptacle

BULKHEAD STRAIGHT JACK-FRONT MOUNT

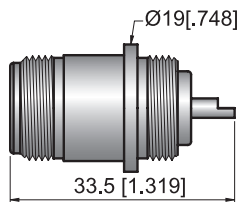

| Part Number. | Cable Type | Dimension | |
|--------------|------------|-----------|---|
| | | A | B |
| N-C5714102Z0 | | | |

Panel Receptacle

4-HOLE PANEL STRAIGHT PLUG

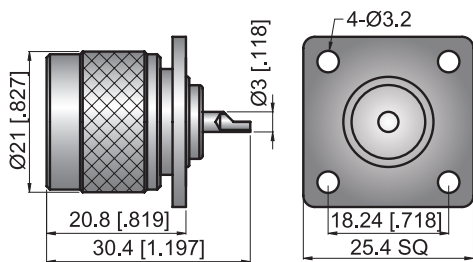

| Part Number. | Cable Type | Dimension | |
|--------------|------------|-----------|---|
| | | A | B |
| N-C5615101Z0 | | | |

Panel Receptacle

4-HOLE PANEL STRAIGHT JACK

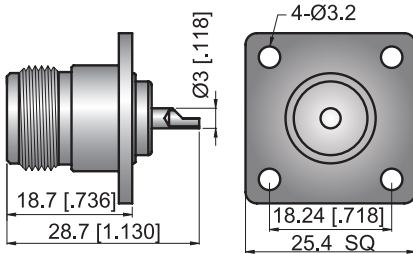

| Part Number. | Cable Type | Dimension | |
|--------------|------------|-----------|---|
| | | A | B |
| N-C5715103Z0 | | | |

Panel Receptacle

4-HOLE PANEL STRAIGHT JACK

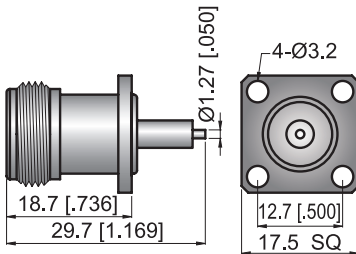

| Part Number. | Cable Type | Dimension | |
|--------------|------------|-----------|---|
| | | A | B |
| N-C5715104Z0 | | | |

Panel Receptacle

4-HOLE PANEL STRAIGHT PLUG

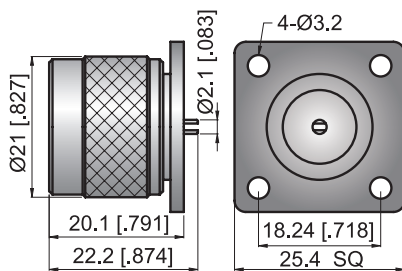

| Part Number. | Cable Type | Dimension | |
|--------------|------------|-----------|---|
| | | A | B |
| N-C5615102Z0 | | | |

Panel Receptacle

4-HOLE PANEL STRAIGHT JACK

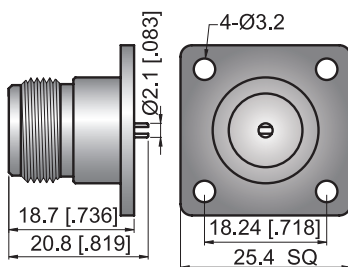

| Part Number. | Cable Type | Dimension | |
|--------------|------------|-----------|---|
| | | A | B |
| N-C5715105Z0 | | | |

Antenna

BULKHEAD STRAIGHT PLUG - FRONT MOUNT

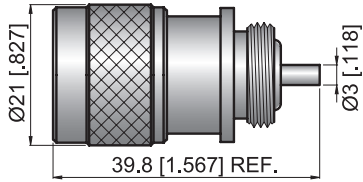

| Part Number. | Cable Type | Dimension | |
|--------------|------------|-----------|---|
| | | A | B |
| N-C5614101A1 | | | |

Antenna

STRAIGHT PLUG, Crimp

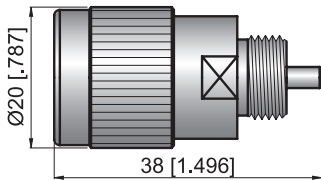

| Part Number. | Cable Type | Dimension | |
|--------------|------------|-----------|---|
| | | A | B |
| N-C5611102A1 | | | |